





**Brings a Mediterranean feeling
to your home.**

The Ergoldsbacher Monaco is a classical, highly profiled, Mediterranean roof tile. Its striking profile gives your roof the play of light and shadow familiar to southern regions.

The "Classic" engobe has been designed in harmonious shades of colour and gives the tile its attractive appearance.

Due to its strong interlocking joint, the Monaco is also very well-suited to the heavy rainfalls of Central Europe.

Classification of additional measures for Ergoldsbacher Monaco,
according to DDH regulations, 22° recommended minimum roof pitch, minimum roof pitch 10°.

Advanced requirements				
Usage of the loft especially for residential use.	Design			Weather conditions
	* for special roof shapes (e.g. butterfly roofs) * for long rafters * for heavily structured roof areas (e.g. due to dormers, channels, etc.)			* exposed position * extreme locations * areas with heavy snow * windy areas * special weather conditions
Roof pitch in degrees (Rafter pitch)	no additional advanced requirement	one additional advanced requirement	two additional advanced requirements	three additional advanced requirements
≥ 22°		roofing membrane	roofing membrane	overlapping or interlocking underlay
≥ 16°	roofing membrane	roofing membrane	overlapping or interlocking underlay	welded or glued underlay
≥ 12°	rain-proof membrane	rain-proof membrane	rain-proof membrane	waterproof membrane
≥ 10°	rain-proof membrane	waterproof membrane	waterproof membrane	waterproof membrane

The additional measures listed in the table are minimum measures. In case of particularly high requirements and/or special local conditions, a higher additional measure should be selected (data sheet for roofing membranes, Table 1, DDH rules). Higher additional measures can always be used instead of minimum measures.

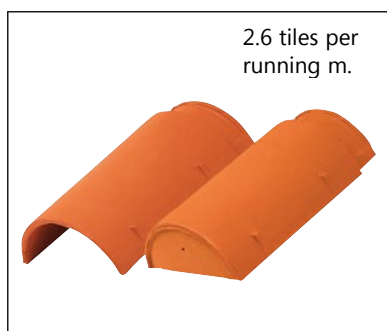

2.6 tiles per
running m.

Ridge tile no. 15

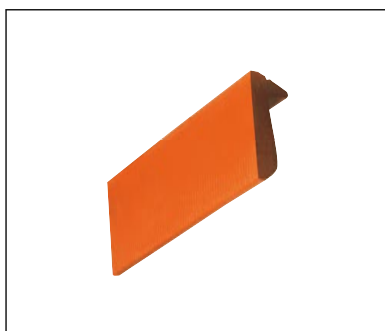

Verge sidepiece



Ridge joint vent left verge



Ridge joint vent right verge



Standard tile



Ridge joint vent



Left verge



Right verge



Ceramic sanitary vent

Like all Ergoldsbacher clay roof tiles, the **Ergoldsbacher Monaco** exceeds the properties required in the roof tile standard DIN EN1304.

Ergoldsbacher roof tiles are a natural building material through and through. You can also tell that they are natural by the way that each tile differs slightly in colour.

As various rules, regulations and professional traditions apply in different European countries, our manufacturer's specifications take priority.

Additional measures to safeguard against wind suction should generally be carried out according to the regulations that apply in each case.

The specified sizes and weights are normal values.

Due to changes in raw material and different shrinkage behaviour, size discrepancies cannot always be avoided.

It is therefore advisable to check the roof dimensions before installing the tiles on site.

Occasional damage is related to production and transport and does not detract from the quality of the roof tiles.

Colours: The Ergoldsbacher Monaco is available in natural red and the engobe classic.

True reproduction of colours cannot be guaranteed in print!

Technical data:

Size:	approx. 25.5 x 42.0 cm
Cover length range:	approx. 33.8 – 34.3 cm
Average cover width:	approx. 19.9 cm
Quantity per m ² :	approx. 14.5 tiles
Weight per tile:	av. 3.8 kg
Weight per m ² incl. battens	
acc. to DIN 1055:	approx. 0.55 kN/m ²
Real weight:	approx. 0.55 kN/m ²

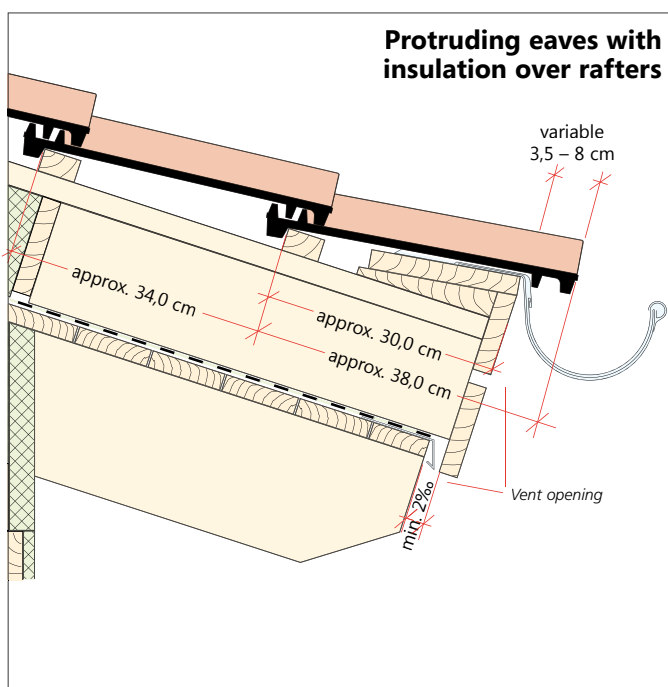
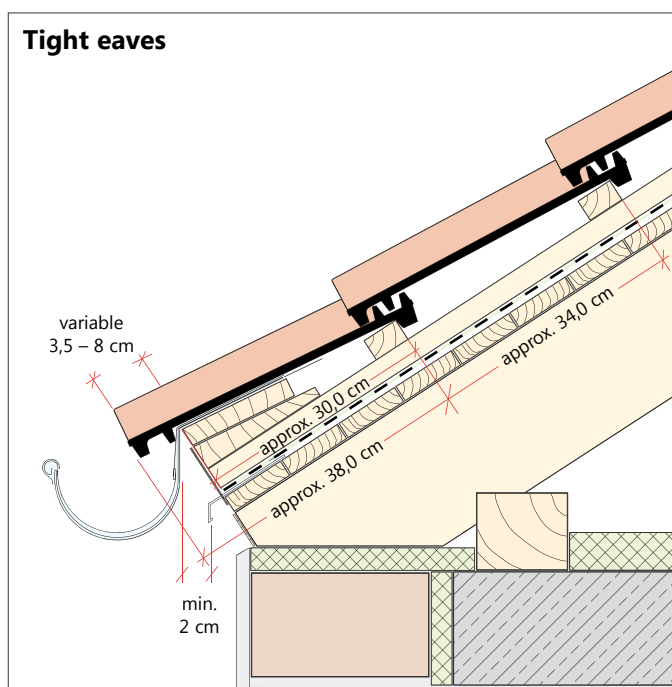
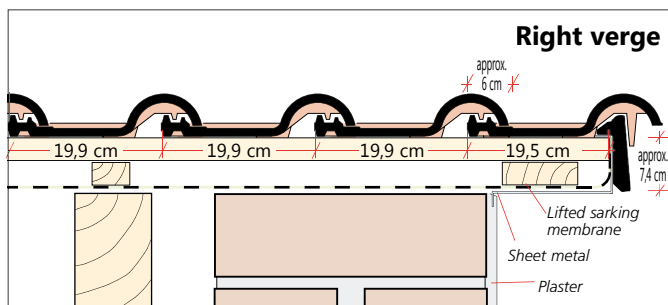
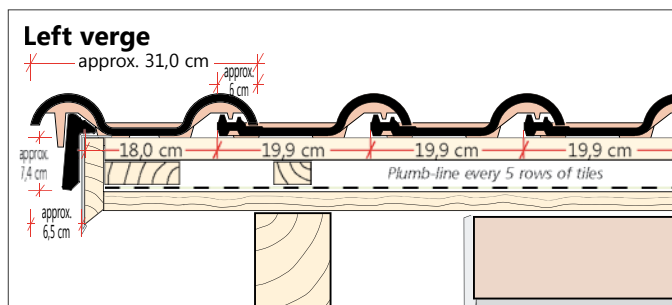
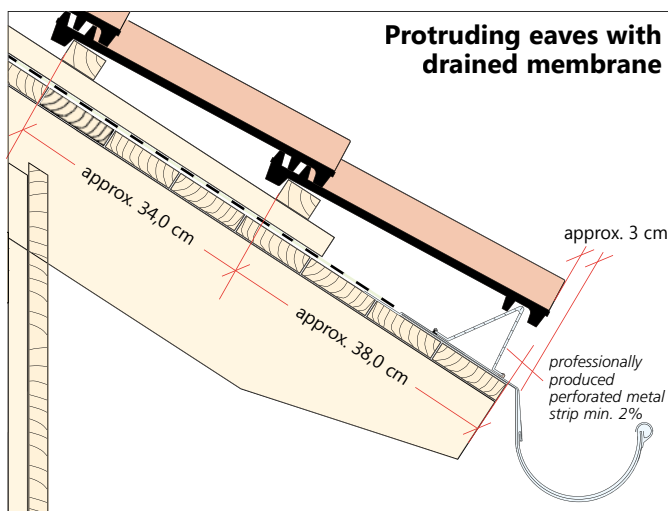
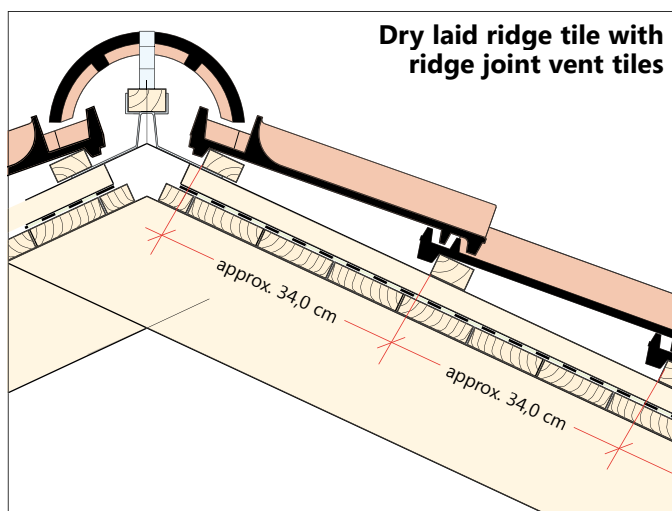

The CAD drawings are done to scale.
The scale shown here is 1:10.

This brochure is valid as at September 2007.

Subject to changes in models and colours.

To help with planning, you can
download all the drawings as
CAD drawings from the Internet
at www.erlus.com.



(Only the colour of the original roof tiles is guaranteed)



Natural red



Engobe classic

Erlus AG**Main office**

Hauptstraße 106 · D-84088 Neufahrn/NB
Tel: +49 (0)8773 18-0 · Fax: +49 (0)8773 18-300
E-Mail: info@erlus.com
Website: www.erlus.com

Erlus Logistics Centre Herrenteich

68766 Hockenheim-Herrenteich
Tel: +49 (0)6205 2095-0 · Fax: +49 (0)8773 18-113

GIMA factory Marklkofen**Girnghuber GmbH**

Ludwig-Girnghuber Str. 1 · D-84163 Marklkofen
Tel: +49 (0)8732 24-0 · Fax: +49 (0)8732 24-200
E-Mail: verkauf@gima-ziegel.de
Website: www.gima-ziegel.de

Erlus Logistics Centre Bassum

Wilh. Detmers-Janssen, haulage
Graf-Zeppelin-Ring 19 · 27211 Bassum
Tel: +49 (0)4241 9393-0 · Telefax: 04241 5050

Erlus Logistics Centre Brüggen

Stiegstraße 99 · 41379 Brüggen
Tel: +49 (0)2157 125954 · Fax: +49 (0)2157 125230

Erlus Logistics Centre Ronneburg

Brunnenstraße 82 · 07580 Ronneburg
Tel: +49 (0)36602 399-18 · Fax: +49 (0)36602 399-75

Erlus Logistics Centre Steinheim**Hermann Enderle, forwarding company**

Talstraße 2 · 71711 Steinheim-Höpfingheim
Tel: +49 (0)7144 21467 · Fax: +49 (0)7144 23066

Erlus AG

Ergoldsbach factory
Industriestraße 7 · D-84061 Ergoldsbach

Sales office / Service desk**for chimney systems**

Tel: +49 (0)8773 18-450, 18-451
Fax: +49 (0)8773 18-455, 18-140

Bernhard tile factory**Erlus factory Teistungen**

Hundeshagener Str. 3 · 37339 Teistungen
Tel: +49 (0)36071 826-23 · Fax: +49 (0)36071 826-22

Handed over by:

Copyright notice

© ERLUS AG 2007. All rights reserved. These copyright protected documents may – even in part – only be copied, modified or transmitted in any form or medium or be saved in a database or other data storage system with the prior consent of ERLUS AG. Any usage without prior consent counts as a breach of the respective copyright terms.